

Shapes

BHY

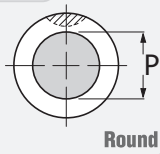

Round

BHO

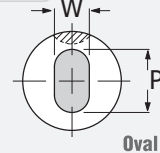

Oval

BHK

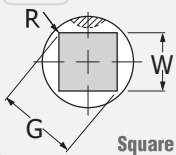

Square

BHD

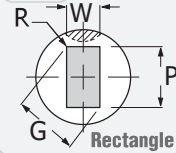

Rectangle

BHA

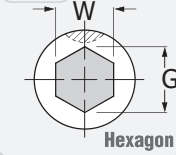

Hexagon

BHM

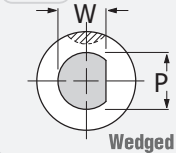

Wedged

BHX

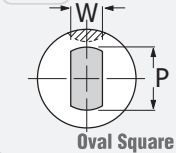

Oval Square

BHP

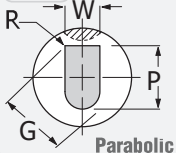

Parabolic

Standard Position

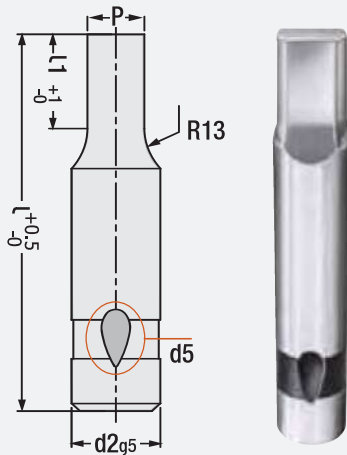
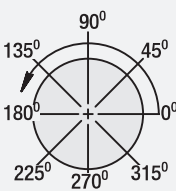

LIGHT DUTY

Ball Lock Stepped Punch - Light Duty

Code: BH..

Types: **BHY - BHO - BHK - BHD - BHA - BHM - BHX - BHP**

← Please refer to the table on the left side

How to order:

Shape
d2
P/W
L1
L
Material

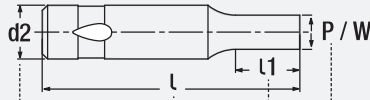

BHY x 10 x P8.2 x 19 x 90 - M2

- When P = d2 shank / body tolerances apply.
- Standard ball socket location is at 90°.

Order d2	Ball Socket d5	d1 / Shape		Standard L1	Alternative L1 Min. Max.		L mm
		(BHY) Round P	Other Shapes W G/P				
BH..06	6	2.2 ~ 5.9	2.2 - 5.9	13	10	-	63
BH..10	8 mm	2.5 ~ 9.9	2.5 - 9.9	19	10	19	71
BH..13		5.0 ~ 12.9	4.5 - 12.9	19	13	25	80
BH..16		8.0 ~ 15.9	6.0 - 15.9	19	13	25	90
BH..20		12 ~ 19.9	8.0 - 19.9	19	13	25	100
BH..25		16 ~ 24.9	10 - 24.9	19	13	25	100
BH..32		24 ~ 31.9	12.5 - 31.9	25	25	30	80
BH..38		30 ~ 37.9	14 - 37.9	25	25	30	90
							100

Order: **BH**(type). d2 x (P/W) x L1 x L

Material: 1.3343 (M2)
Hardness: 60 - 62 HRC

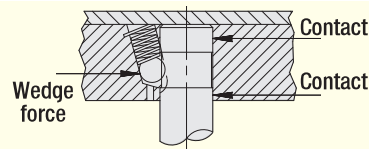

Connecting Punch to Retainer with Ball Socket

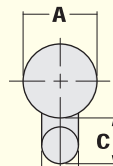

for precise retainers, please add 1.7 to "C" dimension

Requirements of Ball Locking Place

Punch Dia. A	Ball Dia. B	Clearance C
6.0	6.0	10
10	8	11
13		
16		
20		
25		
32		
38		

Light Duty Punch / Matrix

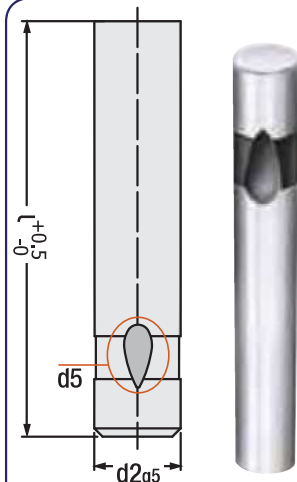

LIGHT DUTY

Punch as per request:



Ball Lock Punch - Light Duty

Code: BHZ

(Blank type)

Body and cutting edge are precision ground. It is for durable parts in all kinds of dies. Also, full or partial coating can be preferred upon request, by providing resistance against heat and friction on external layer, it solves problems such as winding and cold welding, coating thickness is 2 - 4 microns.

d2	d5	L	d2	d5	L
Ø 20 mm	8 mm	63	Ø 6 mm	6 mm	63
		71			71
		80			80
		100			100
		125			125
		150			125
Ø 25 mm	8 mm	175	Ø 10 mm	8 mm	63
		63			71
		71			80
		80			100
		100			110
		125			120
		150			63
Ø 32 mm	8 mm	175	Ø 13 mm	8 mm	71
		200			80
		71			100
		80			125
		100			150
		125			175
		150			175
Ø 38 mm	8 mm	200	Ø 16 mm	8 mm	63
		80			71
		100			80
		125			100
		150			125
		175			150
		200			150

Order: **BHZ**. d2 x L

Material: 1.3343 (M2)
Hardness: 60 - 62 HRC

Note: Special dimensions on request.

Dies

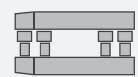

Page

195