

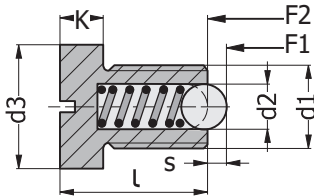

Code: **SBS**

Spring Plunger with Slotted Head

Mounting: Fixing with screwdriver.



It is for locking, compressing upwards and downwards. Fixable with screwdriver.

Heat Resistance Maximum: 250°C.

d1	l	s	d2	d3	K	F1(N)	F2(N)
M6	14	1	3.5	10	5	11	18
M8	16.5	1.5	4.5	13	5	18	31
M10	20	2	6	16	6	24	45
M12	22	2.5	8	18	7	24	49



Order: **SBS. d1**

Material: Steel quality 5.8



Code: **KBS**

Spring Plunger with Bushing

For systems such as elevator and sliding etc.

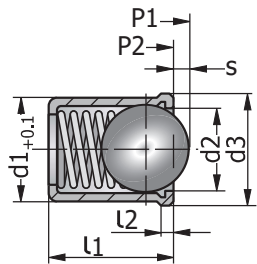

Hole mounting with reamer

d1	l1	d2	d3	l2	s	P1(N)	P2(N)
4	5	3.0	4.6	1	0.90	2	5
5	6	4.0	5.6		1.00	4	7
6	7	5.0	6.5		1.50	6	12
8	9	6.5	8.5		1.80	6	12



Order: **KBS. d1**

Material: Steel quality 5.8



Code: **BSM**

Spring Plunger

Mounting: Fixing with screwdriver.

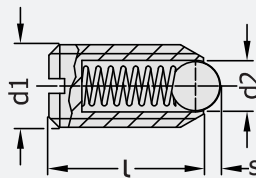

Usage Area:

- Locating
- Pulling, pushing
- Extractor
- Clamping

It is used as core / slide lock etc. in injection mould. As stamp extractor in die and also can be used for bushing of female shafts, limiting the torque tools and positioning of level adjuster. Process able steel bushing - hardened bearing steel ball - winding steel spring.

Heat Resistance Maximum: 250°C.

Code: **BSM**

d1 Thread	l mm	S mm	d2 mm	Initial Force	Final Force
M4	9	0.8	2.5	6 Nw	12 Nw
M5	12	0.9	3.0	7 Nw	13 Nw
M6	14	1.0	3.5	9 Nw	15 Nw
M8	16	1.5	5.0	20 Nw	35 Nw
M10	19	2.0	6.0	25 Nw	45 Nw
M12	22	2.5	8.0	35 Nw	60 Nw
M16	24	3.5	10	65 Nw	110 Nw

* Please don't exceed the force values.

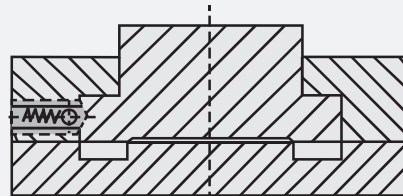

Mounting Example

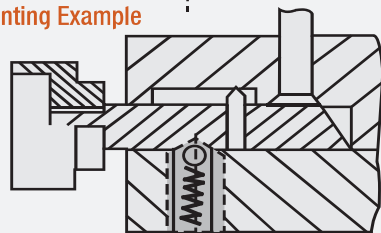

N - Newton = (0.102)Kg.
daN -10 Newton = (1.020)Kg.



Order: **BSM. d1**

Material: Steel quality 5.8



Code: **PSK**

Spring Plunger

Mounting: Fixing with "PMT" mounting kit.

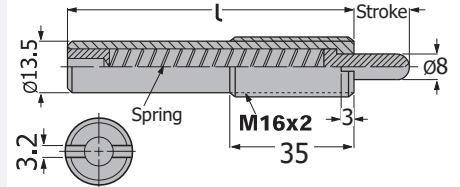

Protective plating that prevents oxidation on the part surface is available. The ball is from steel material and is hardened and polished.

* Please don't exceed the force values.

Stroke	l mm	Initial Force	Final Force
20	80	24 Nw	186 Nw
40	150	59 Nw	177 Nw
60	150	11 Nw	45 Nw
80	200	2 Nw	38 Nw



Order: **PSK. Stroke**

Material: Pin 1.625 Hardness: 40 HRC

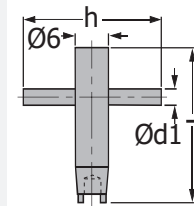

Code: **PMT**

Mounting Kit for Spring Plungers

Spring Plunger (M)	h mm	d Ø	d1 Ø	l mm
M5 - M6	40	6	3	40
M8	45	8	4	45
M10	45	10	4	45
M12	80	12	5	50
M16	70	16	8	52
M24	80	24	12	62
M30	100	30	15	73



Order: **PMT. d x l**

Material: Steel 5.8 Hardness: 36 - 40 HRC

