

Code: BA



Code: BT



Code: BE



Ejector Pin Base (for headless ejector pins)

The ejector base unit is an automatic unit which holds the ejector pin in position until the top is actuated. The pins can be taken out from the front of the tool. Enables quick replacement of ejectors, ejector sleeve and moulding inserts without taking the mould from the press. There is no requirement for strip down when repair or maintenance is needed.

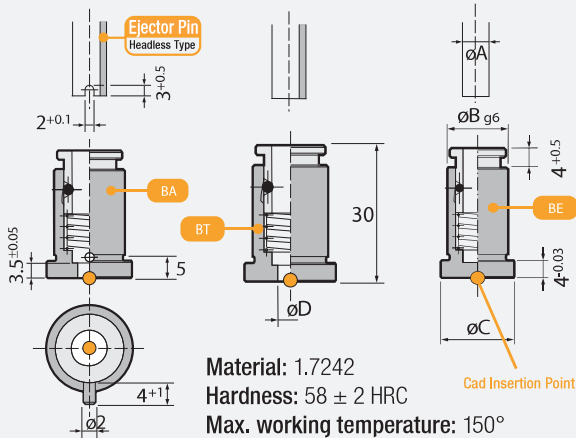

Material: 1.7242
 Hardness: 58 ± 2 HRC
 Max. working temperature: 150°
 Ejector Pin Bases: It is only used for headless ejectors.

Code: BE

Order	A	B	C	CR(N)
BE.031115	3	11	15	≥ 2550
BE.041216	4	12	16	≥ 2550
BE.051317	5	13	17	≥ 3800

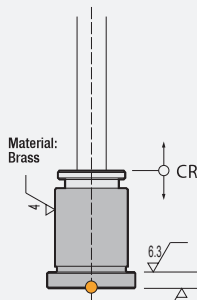

Code: BA

Code: BT

Order	Order	A	B	C	D	
					BA	BT
BA.061418	BT.061418	6	14	18	3.5	4.2
BA.081620	BT.081620	8	16	20	5.5	6.2
BA.101822	BT.101822	10	18	22	7	7
BA.122024	BT.122024	12	20	24	9	9

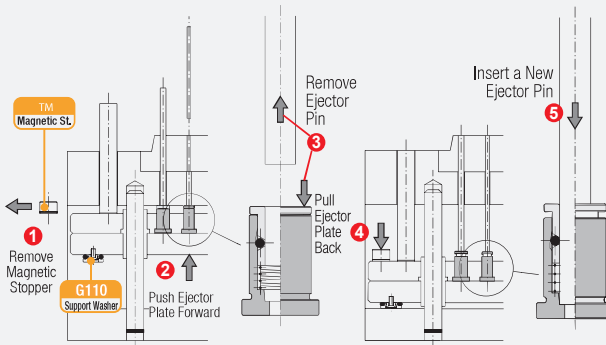

Accelerated Ejector

Code: AE

Allows to increase the stroke of selected ejectors within the tool. It is easy to install due to its cylindrical shape and possible to automate conventional tools. Enables 8mm. / 15mm. / 20 mm. additional stroke on one ejector pin. Only round pockets needed to install the part. Possible to key. Enables quick replacement of the ejector pin.

Material: 1.7225
 Hardness: 54 ± 2 HRC
 Max. working temperature: 150°
 Patented System

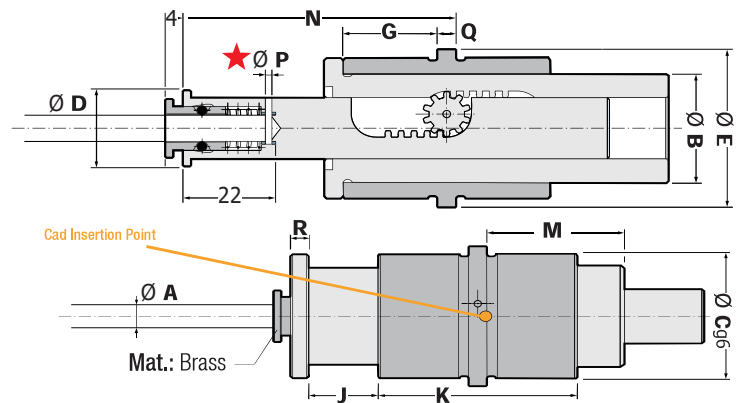

Order	A	B	C	D	E	F	G
AE.031620	3	16	20	12.5	22	13	14
AE.041620	4	16	20	12.5	22	13	14
AE.052430	5	24	30	16	34	16	20
AE.062430	6	24	30	16	34	16	20
AE.082430	8	24	30	17	34	17	20
AE.103036	10	30	36	21.5	40	21	28
AE.123036	12	30	36	21.5	40	21	28

J	K	L	M	N	P	Q	R
8	32	22	17	37	-	4	3
8	32	22	17	37	-	4	3
15	44	36	27	57	2	4	3
15	44	36	27	57	2	4	3
15	44	36	27	57	2	4	3
20	62	46	34	78	2	6	4
20	62	46	34	78	2	6	4

When the internal bushing of this piece gets in contact with the plate, the mechanism starts working. From that point, the ejector of the AE goes at double stroke.

The maximum extra is:

- 8mm (0.315") of extra stroke, with the AE031620 and AE041620.
- 15mm (0.591") of extra stroke, with the AE052430, AE062430 and AE082430.
- 20mm (0.787") of extra stroke, with the AE103036 and AE123036.

★ Possibility to key for using a curved ejector pin. (except AE.031620 & AE.041620)

