

Tolerance  
**h7**

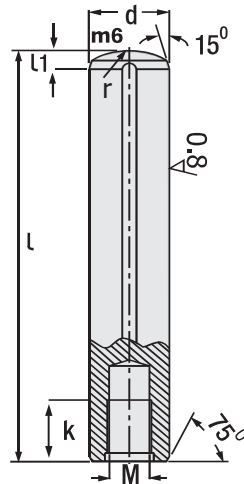

Tolerance  
**m6**



**Dowel Pin with Internal Thread**  
with Air Channel - DIN 7979 / ISO 8735

Code: **CTPh7**

d	l	l1	k	M	r
Ø 6 mm	20	2.1 mm	6 mm	M4	6
	24				
	30				
	36				
	40				
	45				
	50				
	55				
	60				
	70				
80					
90					
100					
h7 0 -12					
Ø 8 mm	20	2.6 mm	8 mm	M5	8
	24				
	30				
	36				
	40				
	45				
	50				
	55				
	60				
	70				
80					
90					
100					
120					
h7 0 -12					
Ø 10 mm	20	3 mm	10 mm	M6	10
	24				
	30				
	36				
	40				
	45				
	50				
	55				
	60				
	70				
80					
90					
100					
120					
h7 0 -15					
Ø 12 mm	20	3.8 mm	10 mm	M6	12
	24				
	30				
	36				
	40				
	45				
	50				
	55				
	60				
	70				
80					
90					
100					
120					
h7 0 -18					
Ø 14 mm	30	4 mm	12 mm	M8	14
	36				
	40				
	45				
	50				
	60				
	70				
	80				
	90				
	100				
120					
140					
h7 0 -18					
Ø 16 mm	30	4.7 mm	12 mm	M8	16
	36				
	40				
	45				
	50				
	60				
	70				
	80				
	90				
	100				
120					
140					
h7 0 -18					
Ø 20 mm	30	6 mm	16 mm	M10	20
	36				
	40				
	45				
	50				
	60				
	70				
	80				
	90				
	100				
120					
150					
h7 0 -21					

Material: 1.7131 (16MnCr 5)  
Hardness: 60 - 62 HRC (Depth 0,8)

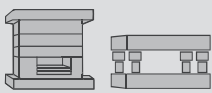

Order: **CTPh7. d x l**

**Dowel Pin with Internal Thread**  
with Air Channel - DIN 7979 / ISO 8735

Code: **CTPm6**

d	l	l1	k	M	r
Ø 5 mm	20	1.7 mm	6 mm	M3	5
	24				
	30				
	36				
	40				
	45				
	50				
	55				
	60				
	70				
80					
m6 +12 +4					
Ø 6 mm	20	2.1 mm	6 mm	M4	6
	24				
	30				
	36				
	40				
	45				
	50				
	55				
	60				
	70				
80					
90					
100					
m6 +15 +6					
Ø 8 mm	20	2.6 mm	8 mm	M5	8
	24				
	30				
	36				
	40				
	45				
	50				
	55				
	60				
	70				
80					
90					
100					
120					
m6 +15 +6					
Ø 10 mm	20	3 mm	10 mm	M6	10
	24				
	30				
	36				
	40				
	45				
	50				
	55				
	60				
	70				
80					
90					
100					
120					
m6 +15 +6					
Ø 12 mm	20	3.8 mm	10 mm	M6	12
	24				
	30				
	36				
	40				
	45				
	50				
	55				
	60				
	70				
80					
90					
100					
120					
m6 +18 +7					
Ø 14 mm	30	4 mm	12 mm	M8	14
	36				
	40				
	45				
	50				
	60				
	70				
	80				
	90				
	100				
120					
140					
m6 +18 +7					
Ø 16 mm	30	4.7 mm	12 mm	M8	16
	36				
	40				
	45				
	50				
	60				
	70				
	80				
	90				
	100				
120					
140					
m6 +18 +7					
Ø 20 mm	30	6 mm	16 mm	M10	20
	36				
	40				
	45				
	50				
	60				
	70				
	80				
	90				
	100				
120					
150					
m6 +21 +8					

Order: **CTPm6. d x l**