

Support Slide for Core Position

Code: **G147**

It can be used also as Bottom Support Plate for Core Guide Block or Guide Block for Inclined Ejector Pin Unit (G133).
Milled, precision ground, perpendicularity controlled and opened fitting holes.

Material: 1.2842 Hardness: 58 + 2 HRC

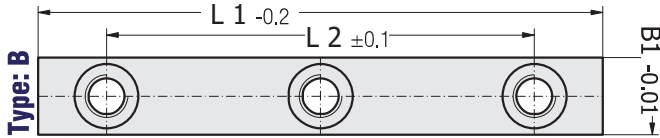
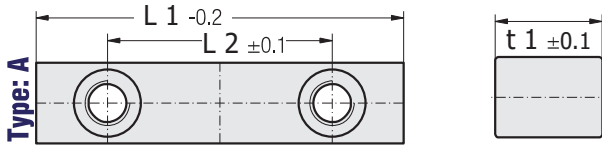

Order	B1	t1	L1	Type	t3	L2	D1	D2	D3
G147.1250	11	11	50	A	5.7	30	10	5.3	M6
G147.1260			60	A		40			
G147.1270			70	B		50			
G147.1275			75	B		60			
G147.1280			80	B		60			
G147.1290			90	B		70			
G147.12100	12	16	100	B	80	11	6.4	M8	
G147.12120			120	B	100				
G147.12140			140	B	120				
G147.12160			160	B	140				
G147.12180			180	B	160				
G147.18100			18	16	100				A
G147.18120	120	A			96				
G147.18140	140	B			116				
G147.18160	160	B			136				
G147.18180	180	B			156				
G147.24140	24	21			140	B	116	11	6.4
G147.24160			160	B	136				
G147.24180			180	B	156				
G147.24200			200	B	176				
G147.24220			220	B	196				

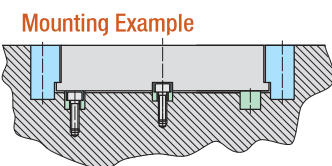
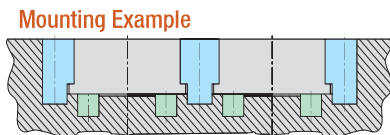

Mounting Example for "G133"

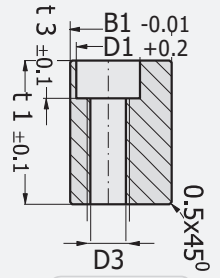
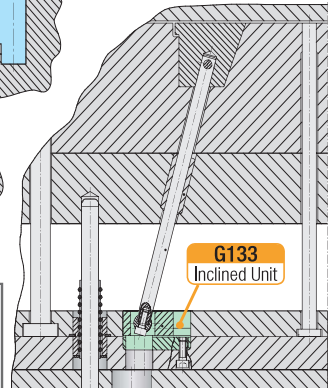

Support Slide for Core Position Side Guide

Code: **G148**

Milled, precision ground, perpendicularity controlled and opened fitting holes.

Material: 1.2842 Hardness: 58 + 2 HRC

Custom-made production can be done as per request.

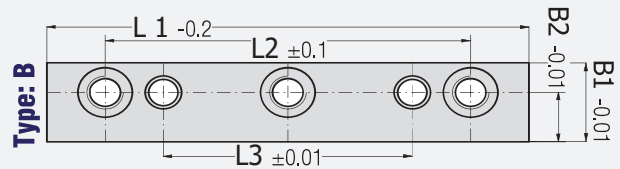
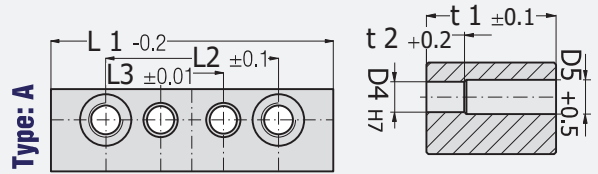

Order	B1	t1	L1	Type	B2	t2	t3	L2	L3	D1	D3	D4	D5
G148.1550	15	11	50	A	9	12	5.7	30	10	10	M6	4	-
G148.1560			60	A				40	20				
G148.1570			70	B				50	30				
G148.1575			75	B				60	40				
G148.1580			80	B				60	40				
G148.1590			90	B				70	50				
G148.1880	18	22	80	A	11	18	6.8	56	32	11	M8	6	7
G148.18100			100	B				76	52				
G148.18120			120	B				96	72				
G148.18140			140	B				116	92				
G148.18160			160	B				136	112				
G148.24100			24	36				100	A				
G148.24120	120	A			88	56							
G148.24140	140	B			108	76							
G148.24160	160	B			128	96							
G148.24180	180	B			148	116							
G148.30120	30	50			120	A	18	18	11	80	40	18	M12
G148.30140			140	A	100	60							
G148.30160			160	B	120	80							
G148.30180			180	B	140	100							
G148.30200			200	B	160	120							

