

NEW



Bar Lock Slide Block

Code: **G152K**

It provides making selections among ready-made products for wide moulds with movable plates more than one for mould designers. During production, insert locks and only wipe outer surfaces. **Please do not touch thin layer of lubrication in joints.**

Order: **G152K. a x l**

Material: 1.2343
Hardness: 58 - 62 HRC

Bar Lock System

Code: **G152**

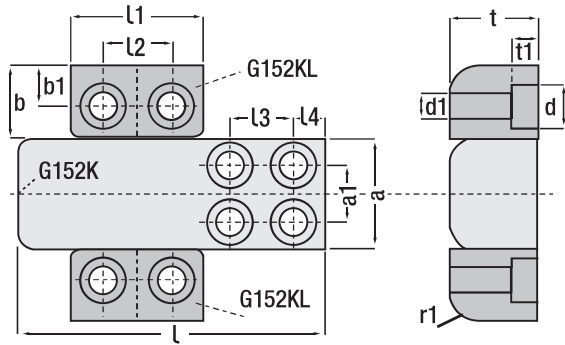

Order: **G152. t x l**

Bar Lock Guide Jaw

Code: **G152KL**

All parts, including part holder rings, are applied a thin layer of oil (fit for food industry) before all areas dry and get hardened. **G152KL** product can be used in group applications for each mould as 2 pieces and multi bar lock guide jaws can be used in different designs.

Order: **G152KL.l1 x b**

Material: 1.2343
Hardness: 52 - 54 HRC

Set Orders (G152): G152K= 1 pcs. + G152KL= 2 pcs.

a g5	l -0.1 / -0.2	l3	l4	a1	t -0.1	l1	b g5	l2	b1	d1 ø	d ø	t1 mm	r1
32	70	18	9	14	22	36	20	16	10	6.6 M.6	11	6.8	6
	90												
	112												
50	90	21	12	24	30	46	25	24	11	9 M.8	15	9	8
	125												
	150												
60	112	26	15	30	32	56	32	30	16	11 M.10	18	11	10
	150												
	175												
80	112	26	15	44	35	56	35	30	16	11 M.10	18	11	12
	150												
	175												
100	175	32	18	55	50	76	40	40	17	13.5 M.12	20	13	15
	200												
	250												
120	200	35	20	75	65	86	45	50	20	13.5 M.12	20	13	15
	250												
	300												

