

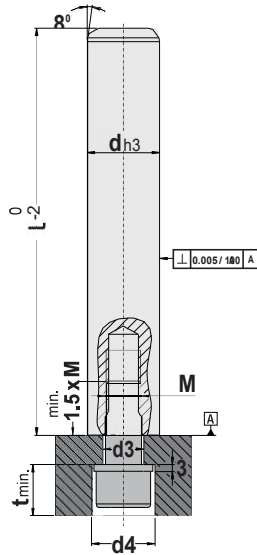

Code: **G166**

Guide Pillar - Bolted Type DIN 9825 / ISO 9182

*G166 is supplied with a screw and washer. GTH guide pillars are polished with surface polishing machine at final stage of production (after grinding).



Hole pattern for pillar fastening:

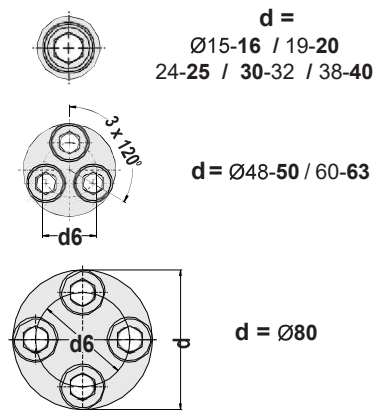

Note: Section (d), two different products are to avoid incorrect closing of die during mounting, three pieces main dimension and one piece auxiliary should be used (d = Ø 16 - 19 - 24 - 32 - 38 - 48 - 60 mm).

If extreme lateral forces are occurred at dies, in these cases, self-lubricating wear plates should be used with pillars.

d mm	d3 mm	d4 mm	d6 mm	t min.	M	mm	Cap Screw	(Nm)
15 16	9	17	-	12	8	90	M8x35	Tightening torque: 21
						100		
						112		
						125		
						140		
						160		
						180		
						200		
						224		
						250		
280								
315								
355								
19 20	11	20	-	14	10	100	M10x40	Tightening torque: 37
						112		
						125		
						140		
						160		
						180		
						200		
						224		
						250		
						280		
315								
355								
400								
24 25	14	22	-	16	12	100	M12x40	Tightening torque: 85
						112		
						125		
						140		
						160		
						180		
						200		
						224		
						250		
						280		
315								
355								
400								
450								
30 32	18	28	-	20.5	16	125	M16x40	Tightening torque: 150
						140		
						160		
						180		
						200		
						224		
						250		
						280		
						315		
						355		
400								
450								
38 40	18	28	-	20.5	16	160	M16x40	Tightening torque: 150
						180		
						200		
						224		
						250		
						280		
						315		
						355		
						400		
						450		
500								
550								
600								
48 50	14	22	28	16	12	180	M12x50	Tightening torque: 85
						200		
						224		
						250		
						280		
						315		
						355		
						400		
						450		
						500		
550								
600								
60 63	18	28	34	20.5	16	250	M16x60	Tightening torque: 200
						280		
						315		
						355		
						400		
						450		
						500		
						550		
						600		
						80		
315								
355								
400								
450								
500								
550								
600								

Order: **G166. d x l**

Material: < Ø 20 = 1.7131
> Ø 20 = 1.1213 (Cf53)
Hardness: 58 - 62 HRC

Operating Components: All sliding systems also can be used with ball cage bush.