

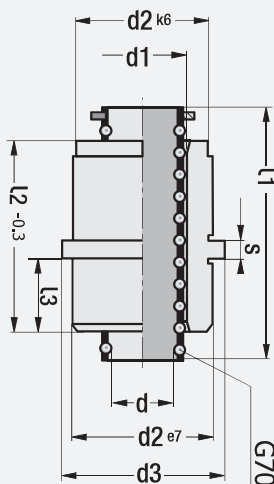

Code: **G29**

## Steel Bush + Ball Cage Bush Set

It provides more precision and rapid motion at ejector plates in injection moulds.



Code: **G29**

d Ø	L1 mm	L2 mm	L3 mm	d1 Ø	d2 Ø	d3 Ø	S mm	H mm
<b>12</b>	40	24	6	16	22	26	6	50
	56							82
<b>18</b>	45	34	11	24	30	35	6	44
	56							66
	71							96
<b>30</b>	56	54	21	38	46	52	6	32
	75							70
	95							110

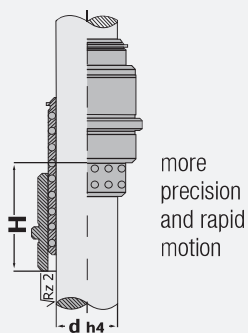

### Mounting Example

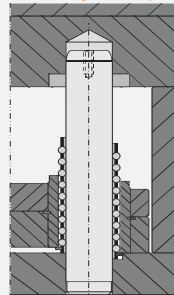

more  
precision  
and rapid  
motion



Order: **G29. d x L1**

Ball Material: 1.3505 (100Cr6)

Cage: Ms58 - Steel Bush: 1.7131 (16MnCr5)

NEW



Code: **G75**

## Linear Ball Bearing Bush

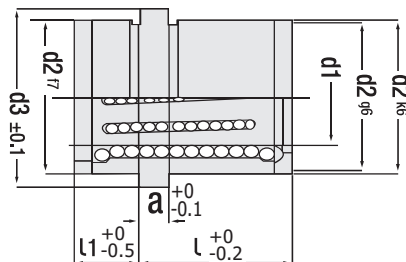

### WARNING!

During production stage of **G74 & G75** products ball bearings are positioned at a certain angle. Other imitation products has no angle and the balls are at a single centre.

Free stroke, rapid and limitless movement.  
New for ejector plate.

Operating Temp.: Max. 200°

Code: **G75**

d1 Ø	L mm	d2 Ø	d3 Ø	a mm	L1 mm	Ball Ø
<b>12</b>	22	24	28	6	8	3
<b>18</b>	26	30	34	6	9	3
<b>20</b>	26	32	36	6	9	3
	36					
<b>25</b>	26	40	45	6	10	3
	36					
	46					
<b>30</b>	46	48	54	8	12	4
	66					
<b>40</b>	46	60	66	8	12	4
	66					

### New Linear Ball Bearing Bushes G74 / G75:

There are balls at inclined - serial - parallel intermediate channels - lines inside of linear **G74 & G75** bushes (balls move by rotating in slot and frictionless). In this way, axial motion remains limitlessly free. Also, bearing logic is provided to the steel bush.

Compatible Pillar: **G18**

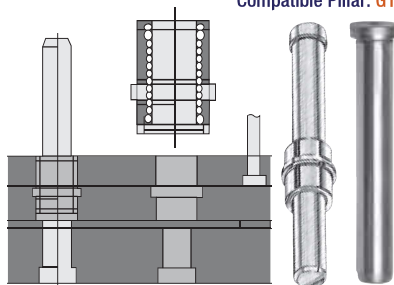

NEW



Code: **G74**

## Linear Ball Bearing Bush - Headed

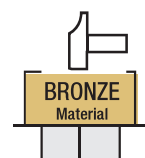
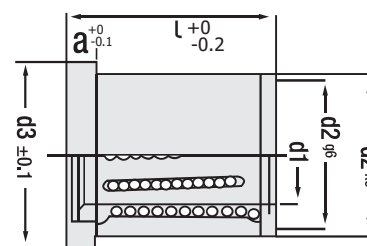

**Positioning**  
Pls, do not make direct fitting.  
Precision assembly recommended with bronze / brass.

Balls are worked independently by rotating, they are not frictional.

Operating Temp.: Max. 200°

Code: **G74**

d1 Ø	L mm	d2 Ø	d3 Ø	a mm	Ball Ø	Line Pcs.
<b>18</b>	35	30	34	6	3	6
<b>20</b>	35	32	36	6	3	6
	45					
	55					
<b>30</b>	45	48	54	8	4	8
	63					
<b>40</b>	45	60	66	8	4	8
	63					

### The advantage of our new product G75 according to other similar product G29:

Extra stroke distances at unlimited axial direction and robust powerful centering is provided - free motion unlimited with low tolerance absorbs other pinking and tauting.

It is presented unlimited motion advantages with compatibility to high speeds. Linear bush **G75**: Rigidity in centering with free axial motion at long ejector systems of injection moulds - unlimited frictional motion. Linear bush **G74**: Quality control equipments - practical and reliable product for machine and mould production and device design. For maintenance and cleaning: "Guvenal Signum" spray oil is used.

Order:

**G75. d1 x L | G74. d1 x L**

Page

**69**