

Wear Plate, ISO 9183-1

Code: **G89**

Self-Lubricating, Thickness: 20 mm / Form: A - B - C - D - E - F

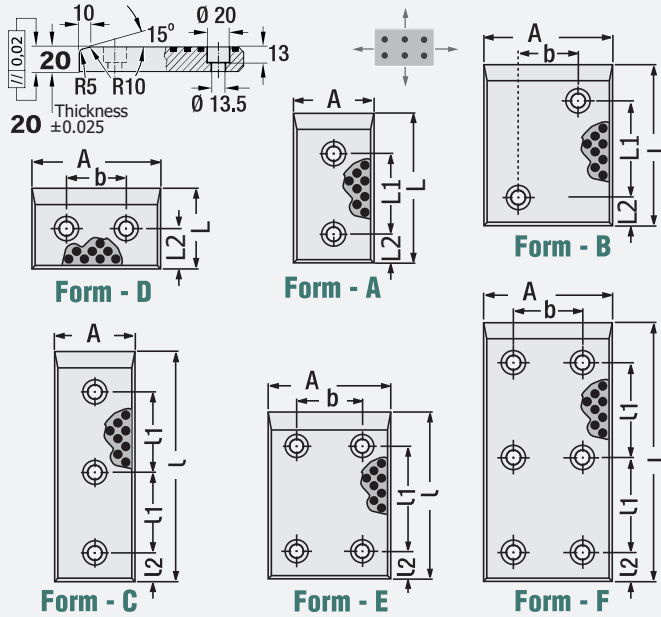

Code: **G89**

A	l	l1	l2	b	Form
50	80	35	20	-	A
	100	55			
	125	80			
	160	115			
	200	155			
	250	100			C
80	50	-	25	40	D
	80	35	20	40	B
	100	55			
	125	80			
	160	115			E
	200	155			
250	100				
315	132	F			
100	50	-	25	60	D
	80	35	20	60	B
	100	55			
	125	80			
	160	115			E
	200	155			
250	100				
315	132	F			

A	l	l1	l2	b	Form
125	50	-	25	85	D
	80	35	20	85	B
	100	55	20	85	E
	125	80			
	160	115			
	200	155			F
250	100				
315	132				
160	50	-	25	120	D
	80	35	20	120	E
	100	55			
	125	80			
	160	115			F
	200	155			
250	100				
315	132				

* Heat Resistance 150°C.

* Fixing screws: M12 x 25.



Order: **G89**. A x L

Wear Plate

Code: **G88**

Self-Lubricating, Thickness: 20 mm / Form: A - B - C

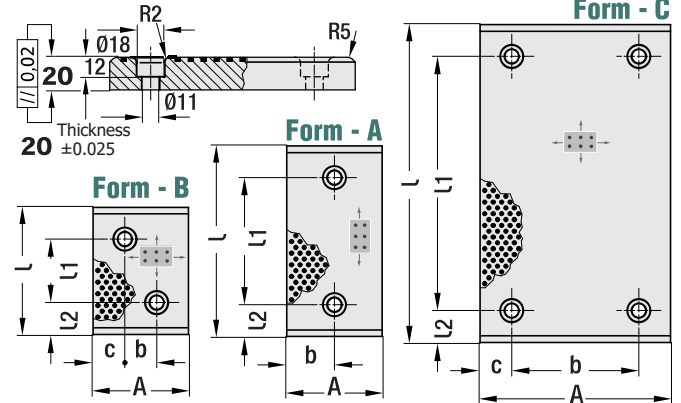

* Please specify Form A - B - C when placing order.

Code: **G88**

A	l	l1	l2	c	b	Form	
28	75	45	15	-	14	A	
	100	50					
	125	75					
	150	100					
38	75	45	15	-	19	A	
	100	50					
	125	75					
	150	100					
48	75	45	15	-	24	A	
	100	50					
	125	75					
	150	100					
58	75	45	15	-	29	A	
	100	50					
	150	100					
75	75	45	15	-	37.5	A	
	75	25	25		25	B	
	100	50			37.5	A	
	100	50			25	25	B
	125	75			-	37.5	A
	150	100				37.5	A
200	150	37.5					

* Heat Resistance 150°C.

* Fixing screws: M10 x 25.



Order: **G88**. A x L x Form

A	l	l1	l2	c	b	Form
100	100	50	25	25	50	C
	125	75				
	150	100				
	200	150				
	250	200				
125	125	75	25	37.5	50	C
	150	100				
	200	150				
	250	200				
	300	250				
150	150	100	25	25	100	C
	200	150				
	250	200				
	300	250				
200	200	150	25	25	150	C
	250	200				
	300	250				

Advantages of Self-Lub. Wear Plate:

- Highly compatible with sudden movements.
- Maximum load carrying capacity at high speeds.
- Can be used under water or with chemical solutions.
- Wide range of temperature resistance.
- Resistant to impact in case of vibration.

Dies



Page

85