

Fittings used in Hot Runner Systems: Inlet, Stopping Disc, Hub Disc & Extractor Tool for Nozzle



Manifold Inlet

Code: **SA**

Inlet is the first element that provides the start of distribution of melt raw material into Manifold.

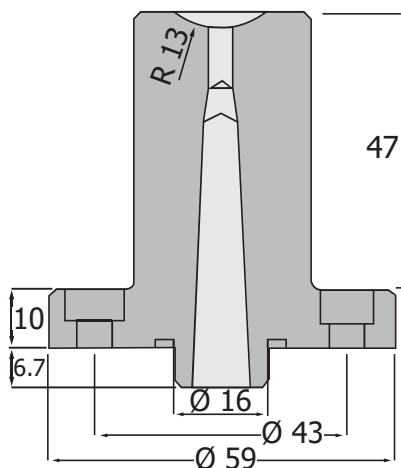

Order: **SA0100V02**



Stopping Disc

Code: **SD03**

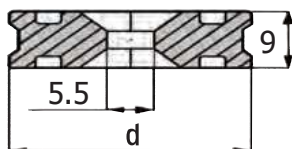

d
28
34



Order: **SD03.00V02 x (d)**

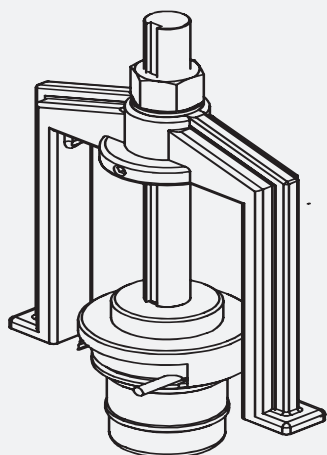

Extractor Tool for Hot Runner Nozzle

Code: **MCA**

In extractor process of Hot Runner Nozzles from mould plate, it is used in extractor / dismantle processes not to damage Hot Runner Nozzles.

D: 18 - 22 - 25 - 32 - 40

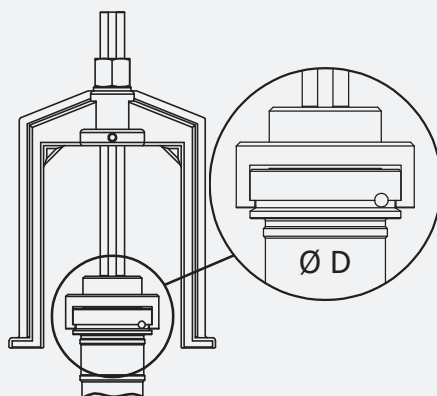

Order: **MCA**



Hub Disc

Code: **SD02**

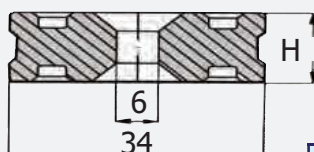

H
13
20



Order: **SD02.00V01 x (H)**

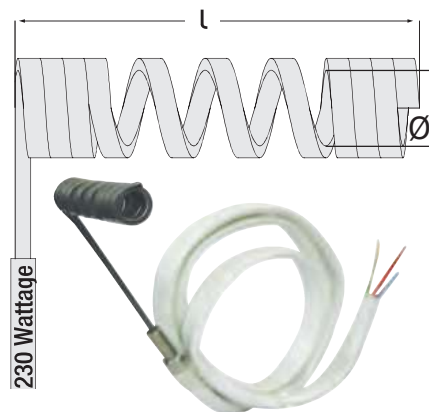

Coil Heater

Code: **SR**

For necessary information; please refer to **page-299**.

Heaters (wattage)
200
225
250
290
350
400
470
620

Heaters (wattage)
690
850
950
1100
1200
1400
1600

Mantle Thermocouple

Code: **MT015**

In Valve Gate System Hot Runner Nozzles. It is a Thermocouple providing to make precision temperature from body.

Note: "d1" and "L" dimensions can be produced as per request.

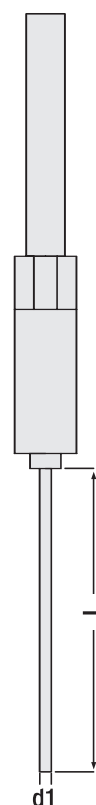

Order Code	d1	L
MT01580	Ø 1.5 mm	80
MT015100		100
MT015120		120

