

For your order of special dimensions, technical drawing can be used:

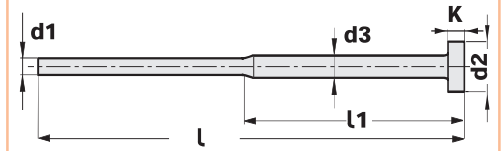

Cylinder Head Stepped Ejector Pin / DIN ISO 8694

Code: **SBKAH**

Material: 1.2516 WS
 Head Hardness: 45 ± 2 HRC
 Body Hardness: 60 ± 2 HRC

Heat Resistance: 220° max.
 Tensile Resistance: 1300 N / mm²

As per request / Custom-made orders.

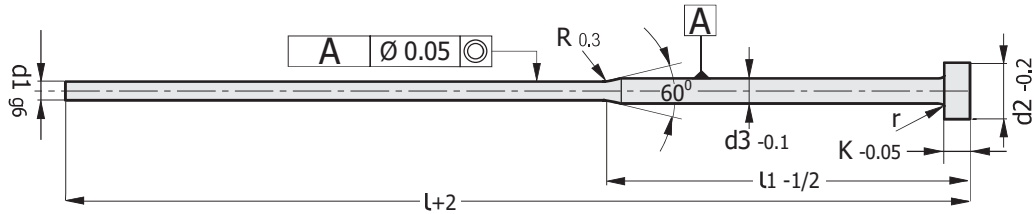

Type: AH

Code: **SBKAH**

d1	l	l1	d3	d2	k
0.8	63	25	2	4	2
	80	35			
	100	50			
	125				
	150				
	160				
1.0	63	25	2	4	2
	80	35			
	100	50			
	125				
	150				
	160				
200	75				
1.1	63	25	2	4	2
	80	35			
	100	50			
	125				
	150				
	160				
200	75				
1.2	63	25	2	4	2
	80	35			
	100	50			
	125				
	150				
	160				
200	75				
1.3	63	25	2	4	2
	80	35			
	100	50			
	125				
	150				
	160				
200	75				
1.4	63	25	2	4	2
	80	35			
	100	50			
	125				
	150				
	160				
200	75				
1.5	63	25	3	6	3
	80	35			
	100	50			
	125				
	150				
	160				
200	75				
1.6	80	35	3	6	3
	100	50			
	125				
	150				
	160				
	200	75			
1.7	80	35	3	6	3
	100	50			
	125				
	150				
	160				
	200	75			
1.8	80	35	3	6	3
	100	50			
	125				
	150				
	160				
	200	75			
2.0	80	35	3	6	3
	100	50			
	125				
	150				
	160				
	200	75			
2.2	80	35	3	6	3
	100	50			
	125				
	150				
	160				
	200	75			
2.5	100	50	3	6	3
	125				
	150				
	160				
	200	75			
	2.6	100			
125					
150					
160		75			
200		75			
2.7		100	50	3	6
	125				
	150				
	160	75			
	200	75			
	2.8	100	50		
125					
150					
160		75			
200		75			

